

# Compiled Project List - J. Matthew Brown, AIA, REFP founder of



Note: Unless specifically listed under the "JMB2 Architecture Cooperative" heading, the lists below indicate the personal project experience of J. Matthew Brown, AIA gained while serving as a project team member with the companies heading each outline segment. The specific roles and phases that applied to each project varied from project to project, ranging from project architect/chief architect to project manager and from schematics to construction administration. Additional detailed project information, including project size, construction cost, special phasing or specific role/phase that I was associated with are available upon request. \*Project received professional award or recognition.

## **- SHW Group, LLP – (1990-2008) -**

Note: The list below represents a partial list of the projects that I was personally associated with as a project team member with SHW Group, LLP.

### **New Educational Projects:**

#### **High Schools:**

- Goose Creek – Goose Creek Memorial High School (including - stadiums, auditorium)
- \*Spring – Academy at Wunsche (new concept school)
- \*Spring – Andy Dekaney HS – (including - natatorium, stadium, auditorium)
- Alvin – New Manvel HS - (including - natatorium, stadium, auditorium)
- DC – Woodson HS - (including - natatorium, stadium, auditorium)
- \*Princeton – New HS
- \*AZ – Agua Fria, Desert Edge HS
- Ft. Bend – George Bush HS #9 (proto) (including - auditorium)
- \*MD – Century HS (proto) (auditorium)
- Quinlan – New HS (proto) (auditorium)
- Mexico – New High School – American School Foundation of Mexico (ASFM)
- MD – Prince George – Northwestern H.S. (including - auditorium, stadium)
- AZ – Amphitheater HS (including - outdoor natatorium, stadium, auditorium, semi-pro baseball, public library)
- \*MD – Northwestern HS (including stadium)
- NC – Forestview (Gastonia) HS (including - auditorium)
- \*MD – Montgomery Blair HS (including - auditorium)
- \*MD – Fauquier, Liberty HS (including - auditorium)
- VA – Wake County HS (including - auditorium)

#### **Middle Schools:**

- Cy-Fair – MS #14 (resite/+ natatorium, stadium)
- Quinlan – New Intermediate School
- AZ – Johnson Ranch Int. – Florence
- Car-FarBra – Dave Blair Int. School
- Lewisville – Hebron Pkwy MS (resite)
- Waxahatchie – 9th Grade Academy
- \*Cy-Fair – Aragon MS #11 (proto)
- Lewisville – J.L. Huffines MS (resite)
- \*Lewisville – McKamy MS (proto)
- \*McKinney – Ruth Dowell MS (proto)
- Pflugerville – 9th Grade Ctr / Connally HS
- VA – Fallston MS

#### **Elementary Schools:**

- Ft. Bend – Quail Valley ES (2-story)
- Mexico – New Elementary School – American School Foundation of Mexico (ASFM)
- Houston – Gregory Lincoln Education Center
- Columbia-Brazoria – \*First Capital ES
- Ft. Bend – Oakland ES (proto)
- Elgin – ES #3
- Plugerville – ES #12 (new resite proto)
- \*Whitesboro – Hayes Primary School
- \*Spring – Clark Intermediate School (3-5)
- Alvin – Don Jeter ES #10
- Alvin – Mary Burks Marek ES #11 (resite)

- Carr-FarBra – Valley Ranch ES (resite)
- Carr-FarBra – Riverchase ES (resite)
- Ft Worth – Seminary Hills Park ES #6 (2-stry - proto)
- Ft Worth – Dolores Huerta ES #9 (2-stry - resite)
- Houston – Park Place ES
- \*Celina – New ES (proto)
- MD – Glen Haven ES
- Cy-Fair – Birkes E.S. #36 (resite)
- Ft Worth – NE 28th & Fairview ES #7 (resite)
- Ft Worth – MG Ellis Primary #8 (80% add/ren)
- AZ – Gadsden ES
- Waller – Fields ES #4 (resite)
- LA – John J. Johnson ES -Lake Charles
- Ft. Worth – Cesar Chavez ES #5 (resite)
- Ft Worth – L. Clifford Davis ES #4 (resite)
- AZ – Canon ES
- AZ – Sine E.S. (new bldg/add)
- AZ – Camp Verde ES
- \*Cy-Fair – Shirley Kirk ES #31 (proto)
- Ft Worth – Mojave Trail ES #3 (resite)
- Ft Worth – Lubbock Ave ES #2 (resite)
- Ft Worth – Lowery ES #1 (proto)
- \*Waxahatchie – Marvin ES
- MD – Northwest ES #6 – Spec. Educ. Ctr
- McKinney – Earl & Lottie Wolford ES (resite)
- Plano – Centennial (Ventura) ES (resite)
- Plano – Wyatt ES (resite)
- Plano – Stinson E.S. (resite)
- Lewisville – Rabbit Run ES (resite)
- Lewisville – Corporate ES (resite)
- \*Rockwall – Dorothy Smith Pullen ES #7 (resite)
- Waxahatchie – E.B. Wedgeworth E.S.
- Plano – Beatty E.S. (resite +)
- \*Plano – Hightower ES (resite)
- Plano – Beverly ES (resite)
- Rockwall – Heath ES
- \*Dallas – Burnet Relief ES
- \*Bellville – O'Bryant Primary School (PK-3)
- Rockwall – Nebbie Williams ES (proto)
- Plano – Bettye Haun ES (resite)
- Plano – Skaggs ES (resite)
- Plano – Barksdale ES (resite)
- Plano – Gullledge ES (proto)

#### **Sports Facilities:**

- Quinlan – Ford HS Fieldhouse
- \*Tomball ISD – Tomball District Natatorium
- Frisco – District Natatorium
- Wylie – District Stadium
- Ft Bend – Kenneth Hall Stadium
- Ft Bend – Buddy Hopson Fieldhouse
- Ft Bend – Don Cooke District Natatorium
- AZ – Ganado Fieldhouse / Arena
- Waxahatchie – Multi-Purpose
- Midlothian – Baseball TIT. / Conc. Bldg.
- VA – Fredricksburg Maury Fieldhouse
- Eldorado Hills – HS New Gym & Café (add)

## **- SHW Group, LLP – ("New" continued) -**

### **College/University:**

- Grayson CC - South Grayson Center
- Blinn College Building – Phase 3 – Bryan Campus
- Austin College - Wortham Center

### **Misc Projects:**

- Celina - Vocational Center
- \*Region X Educational Service Center
- Lewisville - Learning Center
- Lewisville - Athletic Director's Offices
- AZ - Yuma Medical Office Building (proto)
- Carthage - New Transportation Center
- Hemstead - ES Cafetorium

## **Additions/Renovations Educational Projects:**

### **High Schools:**

- Strake Jesuit Student Center, Dining Hall and Chapel
- Sweeny – HS (80% add/ren)
- Westlake - HS (80% add/ren)
- Celina - HS (add)
- Plano - Shepton HS (ren/TAS)
- Lewisville - Lewisville H.S. - P1 (add/ren)
- Houston – Sam Houston HS ROTC (add/ren)
- Cuero - HS add - (2 schools)
- Bellville - HS (add/ren)
- Kilgore - HS (add/ren)
- MD - George Mason HS (add/ren)

### **Middle Schools:**

- Spring - Twin Creeks & Dueitt M.S. - (add/ren)
- Princeton - Clark MS Band Hall (ren), new entry (add)
- Sherman - Piner MS & New Life Center (ren)
- Waller - Shultz MS (add + TAS)
- Waxahatchie - Turner MS (ren)
- Waxahatchie - JH (add/ren)
- Lewisville - Delay MS – Pi & P2 (ren)
- Lewisville - Forestwood MS (add)
- Carr-FarBra - Davis ES (add/ren)
- Waxahatchie - JH (add)
- Bellville - JH (ren/add)
- LaMarque - P3 - MS (add/ren)

### **Elementary Schools:**

- Irving – (3) ES - (ren)
- Quinlan - DC Cannon ES - (add)

- Plano - ES Add/Ren – Phase I (3 schools)
- Plano - ES Add/Ren – Phase II (13 schools)
- Plano - ES Add/Ren – Phase III (14 schools)
- Keller - Canopies / Entries (10 schools)
- Whitesboro Primary School (80% add/ren)
- Spring - Oak Creek ES (add/ren)
- Carr-FarBra - Davis ES (80% add/ren)
- \*MD - Holly Hall E.S. (80% Add/Ren)
- DE - Seaford-Blade & West ES (add/ren)
- MD - Bannecker ES (add/ren)
- Lewisville - ES Additions (5 schools)
- MD - Northeast ES (add/ren)

### **Sports Facilities:**

- Goose Creek – Stallworth Stadium New Pressbox and Improvements
- Waxahatchie - Fieldhouse (add)

### **College/University:**

- Grayson Co. College - Admin bldg (add/ren)
- Austin College – (3) student housing projects (ren)

### **Misc Projects:**

- Goose Creek – MOTS Building and Site Improvements
- Pflugerville - District Admin Bldg (add#2)
- AZ - Ganado Library/Café. (add)
- Calhoun - (5) Misc projects (add/ren)
- Carthage - (4) Misc projects (add/ren)
- Castleberry – HS, MS, ES - add/ren (9 schools)

## **- Eric Davy, AIA & Associates, Inc. (EDA) – (1989-1990) -**

### **Medical:**

- CA, Vista Medical Office Building (Kaiser Permanente)

### **Commercial:**

- CA, Creekside Mixed Use Development (12 buildings)
- Mexico, Club Rosarita Beach Club

## **- Krommenhoek/McKeown & Associates, Inc. (KM&A) – (1988-1989) -**

### **Institutional:**

- \*CA, Costa Real Municipal Water District Operations Center

### **Government:**

- CA, 29 Palms Marine Base Additions

### **Commercial:**

- CA, WA, AZ, CO, Great American Bank (20+/- various branches)
- Rancho Del Oro, Totem Lake, Fiesta Mall, Del Mar, Indian Wells, Bonita Point, Friars – Mission Center, Tacoma WA, Mesa AZ
- \*Great American Tower, Main Bank Pedestrian Concourse

## **- The Terry Group, Inc. – (1986-1988) -**

### **Medical:**

- CA, Vista San Diego Residential Treatment Center
- CA, Vista Hill Hospital, Master Plan
- CA, Vista Hill Hospital Additions
- CA, Mesa Vista Hospital, CAT Building Lobby Addition/Renov

### **Government:**

- CA, San Diego Naval Base, Building #7 and #19, survey & assessment of existing base police facilities
- CA, Naval Seals Training Station, survey and assessment of existing facilities

## **- Six Construction Co., Inc. – (1985) -**

### **Commercial:**

- TX, Peterbilt Trucking Facility
- \*TX, Century 21 Offices
- TX, Pinnacle Peak Restaurant

# Compiled Professional Project Awards & Recognition List

- J. Matthew Brown, AIA, REFP founder of



**Note:** Unless specifically listed under the "JMB2 Architecture Cooperative" heading, the lists below indicate the personal project experience of J. Matthew Brown, AIA gained while serving as a project team member with SHW Group, LLP (U.O.N.). The specific roles and phases that applied to each project varied from project to project, ranging from project architect/chief architect to project manager and from schematics to construction administration. Additional detailed project information, including project size, construction cost, special phasing or specific role/phase that I was associated with are available upon request.

**Note:** U.O.N. on the projects listed below, I served as a project team member with SHW Group, LLP, while either a partner or employee. Specific project Roles and Specific project Phases that apply to each project team are listed in parenthesis.

**Role:** PA – Project Architect, Chf – Chief Architect, JC – Job Captain, PM – Project Manager

**Phase:** Prog – Programming, Con – Concept, SD – Schematic Design, DD – Design Development, CD – Construction Documents, CA – Construction Administration



## **Sweeny High School** – Sweeny, TX – Sweeny ISD (PM, Chf - Prog, Con, SD, DD, CD, CA)

- 2010 TASA/TASB Exhibition of School Architecture  
Design, Value, Innovation
- 2010 Currently Under Review - CEFPI Impact on Learning Awards



## **Goose Creek Memorial High School** – Baytown, TX – Goose Creek Consolidated ISD (PM, Chf - Prog, Con, SD, DD, CD, CA)

- 2009 TASA/TASB Exhibition of School Architecture  
Design, Educational Appropriateness, Value, Innovation



## **Andy Dekaney High School** – Spring, TX – Spring ISD (JC - DD, CD)

- 2008 School Planning & Management Education Design Showcase  
Project of Distinction Winner – K-12 High School Building/Campus Design
- 2008 TASA/TASB Exhibition of School Architecture  
Caudill Award Winner (top school in Texas, 2008)  
Design, Process of Planning, Educational Appropriateness, Value, Innovation



## **Carl Wunsche, Sr. High School** – Spring, TX – Spring ISD (PA - Prog, Con, SD, DD, CD)

- 2008 School Planning & Management Education Design Showcase  
National Grand Prize – K-12 High School Whole Building/Campus Design
- 2007 TASA/TASB Exhibition of School Architecture  
Caudill Award Winner (top school in Texas, 2007)  
Design, Process of Planning, Educational Appropriateness, Value, Innovation
- 2007 CEFPI Impact on Learning Awards  
James D. MacConnell Award Winner (top education facility in the world)



## **First Capital Elementary School** – West Columbia, TX – Columbia-Brazoria ISD (PA- Con, SD, DD, CD)

- 2006 TASA/TASB Exhibition of School Architecture  
Design, Educational Appropriateness, Value, Innovation



## **Hayes Primary School** - Whitesboro, TX – Whitesboro ISD (Chf, PA-SD, DD, CD)

- 2005 CEFPI Impact on Learning Awards  
Outstanding Architecture & Design in Education, Effective Transformation
- 2005 TASA/TASB Exhibition of School Architecture  
Value, Design, Educational Appropriateness, Innovation



## **Princeton High School** – Princeton, TX – Princeton ISD (Chf, PA-SD, DD, CD)

- 2005 TASA/TASB Exhibition of School Architecture  
Process of Planning, Design awards



## **Celina Elementary School** – Celina, TX – Celina ISD (Chf, PA-SD, DD, CD)

- 2004 TASA/TASB Exhibition of School Architecture  
Value, Design, Educational Appropriateness, Innovation awards



## **Region X Education Service Center** – Richardson, TX – Region X Service Area (Chf, PA-SD, DD, CD)

- 2004 TASA/TASB Exhibition of School Architecture  
Design, Innovation awards



**Clark Intermediate School (3-5)** – Houston, TX – Spring ISD (Chf, PA-SD, DD)  
2004 TASA/TASB Exhibition of School Architecture  
Value, Process of Planning awards



**Tomball Natatorium** – Tomball, TX – Tomball ISD (Chf, PA-SD, DD, CD)  
2004 TASA/TASB Exhibition of School Architecture - Design award



**Century High School** – Sykesville, MD – Carroll County Public Schools (Chf, PA-SD, DD)  
2003 American School & University (AS&U) Magazine Education Design Competition  
2002 Crow Island School Citation (top award - only 1 given ea. year)  
American Association of School Administrator (AASA), American Institute of Architects (AIA), and the Council of Educational Facilities Planner International (CEFPI) Citations  
2002 American School & University (AS&U) Magazine Educational Design Competition - Outstanding Design, High School



**Aragon Middle School** – Houston, TX – Cypress-Fairbanks ISD (Chf, PA-SD, DD, CD)  
2003 American School & University (AS&U) Magazine Education Design Competition - Gold Citation Award (1 of 5 given), Middle School  
2002 American School & University (AS&U) Magazine Education Design Competition - Outstanding Design, Middle School



**Marvin Elementary School** – Waxahatchie, TX – Waxahatchie ISD (Chf, PA-SD, DD, CD)  
2003 American School & University (AS&U) Magazine Education Design Competition - Outstanding Design, Elementary School – Common Area  
2002 American School & University (AS&U) Magazine Education Design Competition - Outstanding Design, Elementary School

**Desert Edge High School** – Goodyear, AZ – Aqua Fria Union School District (Chf, PA-SD, DD, CD)  
2002 American School & University (AS&U) Magazine Education Design Competition - Outstanding Design, High School

**Shirley Kirk Elementary School** – Houston, TX - Cypress-Fairbanks ISD (Chf, PA-DD, CD)  
2002 School Planning & Management Education Design Showcase  
Outstanding Architecture & Design in Education

**78<sup>th</sup> Annual CEFPI National Conference Speaker** – Denver, Co  
2002 Title: "Three Codes Merged in a Yellow Wood"  
Topic: Review new IBC 2000 code and discussion of affects on school design



**Holly Hall Elementary School** – Elkton, MD – Cecil Country Public Schools (Chf, PA-SD, DD, CD)  
2001 American School & University (AS&U) Magazine Education Design Competition - Outstanding Design, Elementary School



**Northwestern High School** – Hyattsville, MD – Prince George's Public Schools (Chf, PA-SD, DD, CD)  
2001 American School & University (AS&U) Magazine – Educational Interiors Showcase - Bronze Citation Award for Architectural Excellence, High School



**Hightower Elementary School** – Plano, TX – Plano ISD (PA-SD, DD, CD)  
2000 TASA/TASB Exhibition of School Architecture  
Process of planning award



**Dorothy Smith Pullen Elementary School** – Rockwall, TX – Rockwall ISD (PA-SD, DD, CD proto)  
2000 American School & University (AS&U) Magazine Education Design Competition - Citation Award for Architectural Excellence, Elementary School



**Burnet Relief Elementary School** – Dallas, TX – Dallas ISD (PA-SD, DD CD)  
2000 DISD Bond Issue awards (2 of 3 possible awards in entire \$320m bond package) - Top Design Award and Ease of Construction Award





**Blair High School** – Silver Springs, MD – Montgomery County Public School (JC-CD)

- 2000 American School & University (AS&U) Magazine – Educational Interiors Showcase - Outstanding Design, High School
- 1999 Association of School Business Officials – Award Merit for Architectural excellence
- 1999 CEFPI – Finalist for James D. MacConnell Award
- 1999 AASA – Citation Award for Architectural Excellence



**McKamy Middle School** – Flower Mound, TX – Lewisville ISD (PA-SD, DD, CD)

- 1998 TASA/TASB Exhibition of School Architecture, Middle School Award of Merit
- 1998 American School & University (AS&U) Magazine Education Design Competition - Recognition for Architectural Excellence, Middle School



**O'Bryant Primary School** – Bellville, TX – Belleville ISD (PA-SD, DD, CD)

- 1998 TASA/TASB Exhibition of School Architecture, Elementary School Award of Merit
- 1998 American School & University (AS&U) Magazine Education Design Competition - Recognition for Architectural Excellence, Primary School



**Ruth Dowell Middle School** – McKinney, TX – McKinney ISD (PA-CD)

- 1998 American School Journal - Learning by Design Competition Recognition for architectural excellence, Middle School
- 1997 CEFPI Exhibition of School Architecture, Middle School Award of Merit
- 1996 TASA/TASB Exhibition of School Architecture, Middle School Award of Merit



**Liberty High School** – Fauquier, VA – Fauquier County Public Schools (JC-CD)

- 1995 American School & University (AS&U) Magazine Education Design Competition - Recognition for Architectural Excellence, High School

**Century 21 Offices** – Lubbock, TX (Six Construction Co., Inc) (JC-CD)

- 1985 Avalanche Journal Building of the Month

# J. Matthew Brown, AIA, REFP - Personal Project Type Sampling

FOUNDER OF



## Elementary School Projects

### Various Clients

Houston Area, Texas, National/International



### RECOGNIZED ELEMENTARY SCHOOL PROJECTS

**First Capital Elementary School** – West Columbia, TX – Columbia-Brazoria ISD (PA- Con, SD, DD, CD)

**Hayes Primary School** - Whitesboro, TX – Whitesboro ISD (Chf, PA-SD, DD, CD)

**Celina Elementary School** – Celina, TX – Celina ISD (Chf, PA-SD, DD, CD)

**Clark Intermediate School (3-5)** – Houston, TX – Spring ISD (Chf, PA-SD, DD)

**Marvin Elementary School** – Waxahatchie, TX – Waxahatchie ISD (Chf, PA-SD, DD, CD)

**Shirley Kirk Elementary School** - Houston, TX - Cypress-Fairbanks ISD (Chf, PA-DD, CD)

**Holly Hall Elementary School** – Elkton, MD – Cecil Country Public Schools (Chf, PA-SD, DD, CD)

**Hightower Elementary School** – Plano, TX – Plano ISD (PA-SD, DD, CD)

**Dorothy Smith Pullen Elementary School** – Rockwall, TX – Rockwall ISD (PA-SD, DD, CD proto)

**Burnet Relief Elementary School** – Dallas, TX – Dallas ISD (PA-SD, DD CD)

**O'Bryant Primary School** – Bellville, TX – Belleville ISD (PA-SD, DD, CD)

### ELEMENTARY SCHOOL PROJECT SAMPLING

Quail Valley E.S., New Elementary School – American School Foundation of Mexico (ASFM), First Capital E.S., Oakland E.S., Pflugerville E.S. #12, Don Jeter E.S. #10, Mary Burks Marek E.S. #11, Seminary Hills Park E.S. #6, Camp Verde E.S., Lowery E.S. #1, Marvin E.S., Burnet Relief E.S., O'Bryant Primary School, Nebbie Williams E.S., Gullede E.S., Irving (3) E.S., Plano E.S. Phase III (30), Lewisville E.S.

### CLIENT SAMPLING

Fort Bend ISD, American School Foundation of Mexico, Columbia-Brazoria ISD, Pflugerville ISD, Alvin ISD, Fort Worth ISD, Waxahatchie ISD, Dallas ISD, Bellville ISD, Rockwall ISD, Plano ISD, Irving ISD, Carrollton-Farmers Branch ISD, Lewisville ISD, Elgin ISD

### STATE/COUNTRY SAMPLING

Texas, Arizona, Maryland, Louisiana, Delaware, Mexico, Virginia

### ATTRIBUTION OF CREDITS

Architectural Firm of Record: SHW Group, LLP

SHW Group, LLP – Mark Lam, OIC – 713.877.0900

Architectural Services: J. Matthew Brown, AIA, REFP

### CONTACT J. MATTHEW BROWN, AIA, REFP

JMB2 Architecture Cooperative

J. Matthew Brown, AIA, REFP - 281.980.0900

**DISCLAIMER:** JMB2 Architecture, Inc. is not the architectural firm of record for the above project. Rather, J. Matthew Brown, AIA, REFP served as a project team member, providing the above listed role(s), during the above listed project phases, while engaged with SHW Group, LLP as either firm partner or employee.



# J. Matthew Brown, AIA, REFP - Personal Project Type Sampling

FOUNDER OF



## Middle School Projects

Various Clients

Houston Area, Texas, National



### RECOGNIZED MIDDLE SCHOOL PROJECTS

**Aragon Middle School** – Houston, TX – Cypress-Fairbanks ISD (Chf, PA-SD, DD, CD)

**McKamy Middle School** – Flower Mound, TX – Lewisville ISD (PA-SD, DD, CD)

**Ruth Dowell Middle School** – McKinney, TX – McKinney ISD (PA-CD)

### MIDDLE SCHOOL PROJECT SAMPLING

Cy-Fair M.S. #14, Quinlan New Intermediate School, Johnson Ranch Intermediate, Carrollton-Farmers Branch - Dave Blair Intermediate School, Waxahatchie 9th Grade Academy, Cy-Fair Aragon M.S. #11, McKamy M.S., McKinney - Ruth Dowell M.S., Pflugerville 9th Grade Center/Connally H.S., Twin Creeks & Dueitt M.S., LaMarque - P3 – M.S., Hebron Pkwy M.S., J.L. Huffines M.S., Fallston M.S., Clark M.S. Band Hall, Piner M.S. & New Life Center, Shultz M.S., Turner M.S., Waxahatchie Junior High, Delay M.S. – P1 & P2, Forestwood M.S.

### CLIENT SAMPLING

Cypress-Fairbanks ISD, Waxahatchie ISD, Lewisville ISD, McKinney ISD, Pflugerville ISD, Spring ISD, Carrollton-Farmers Branch ISD, Bellville ISD, Princeton ISD, Sherman ISD, Waller ISD, LaMarque ISD, Calhoun ISD, Carthage ISD, Castleberry ISD

### STATE SAMPLING

Texas, Arizona, Maryland, Virginia

### SCOPE OF SERVICES/ROLES/PHASES

#### PROVIDED BY J. MATTHEW BROWN, AIA, REFP

JMB role/phase – Chf = Chief Architect, PA = Project Architect, JC = Job Captain – Program, SD = Schematics Design, DD = Design Development, CD = Construction Documents, Permit/Bid, CA = Construction Administration

### ATTRIBUTION OF CREDITS

Architectural Firm of Record: SHW Group, LLP  
Architectural Services: J. Matthew Brown, AIA, REFP

### FIRM CONTACT

SHW Group, LLP – Mark Lam, OIC – 713.877.0900

### CONTACT J. MATTHEW BROWN, AIA, REFP

JMB2 Architecture Cooperative  
J. Matthew Brown, AIA, REFP - 281.980.0900

**DISCLAIMER:** JMB2 Architecture, Inc. is not the architectural firm of record for the above project. Rather, J. Matthew Brown, AIA, REFP served as a project team member, providing the above listed role(s), during the above listed project phases, while engaged with SHW Group, LLP as either firm partner or employee.

# J. Matthew Brown, AIA, REFP - Personal Project Type Sampling

FOUNDER OF



## High School Projects

### Various Clients

Houston Area, Texas, National/International

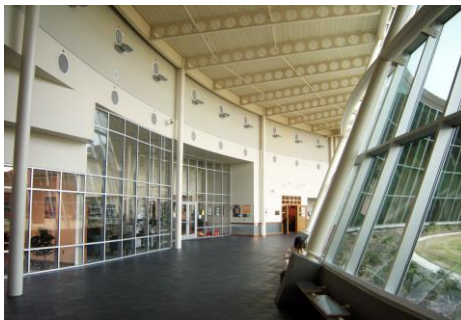

### RECOGNIZED HIGH SCHOOL PROJECTS

**Sweeny High School** – Sweeny, TX – Sweeny ISD (PM, Chf - Prog, Con, SD, DD, CD, CA)

**Goose Creek Memorial High School** – Baytown, TX – Goose Creek Consolidated ISD

**Andy Dekaney High School** – Spring, TX – Spring ISD (JC - DD, CD)

**Carl Wunsche, Sr. High School** – Spring, TX – Spring ISD (PA - Prog, Con, SD, DD, CD)

**Princeton High School** – Princeton, TX – Princeton ISD (Chf, PA-SD, DD, CD)

**Century High School** – Sykesville, MD - Carroll County Public Schools (Chf, PA-SD, DD)

**Desert Edge High School** – Goodyear, AZ – Aqua Fria Union School District (Chf, PA-SD, DD, CD)

**Northwestern High School** – Hyattsville, MD – Prince George's Public Schools (Chf, PA-SD, DD, CD)

**Blair High School** – Silver Springs, MD – Montgomery County Public School (JC-CD)

**Liberty High School** – Fauquier, VA – Fauquier County Public Schools (JC-CD)

### HIGH SCHOOL PROJECT SAMPLING

Goose Creek Memorial High School, Academy at Wunsche, Andy Dekaney H.S., New Manvel H.S., Desert Edge H.S., George Bush H.S. #9, New High School – American School Foundation of Mexico (ASFM) and Paraguay, Amphitheater H.S., Northwestern H.S., Montgomery Blair H.S., Fauquier Liberty H.S., Strake Jesuit Student Center, Dining Hall and Chapel, Sweeny H.S., Westlake H.S.

### CLIENT SAMPLING

Goose Creek ISD, Spring ISD, Alvin ISD, Fort Bend ISD, American School Foundation of Mexico, Strake Jesuit College Preparatory, Sweeny ISD, Westlake ISD

### STATE/COUNTRY SAMPLING

Texas, Arizona, Maryland, Virginia, Mexico, Paraguay

### ATTRIBUTION OF CREDITS

Architectural Firm of Record: SHW Group, LLP

SHW Group, LLP – Mark Lam, OIC – 713.877.0900

Architectural Services: J. Matthew Brown, AIA, REFP

### CONTACT J. MATTHEW BROWN, AIA, REFP

JMB2 Architecture Cooperative

J. Matthew Brown, AIA, REFP - 281.980.0900

**DISCLAIMER:** JMB2 Architecture, Inc. is not the architectural firm of record for the above project. Rather, J. Matthew Brown, AIA, REFP served as a project team member, providing the above listed role(s), during the above listed project phases, while engaged with SHW Group, LLP as either firm partner or employee.



# J. Matthew Brown, AIA, REFP - Personal Project Type Sampling

FOUNDER OF



## Higher Education Projects

Various Clients

Houston Area, Texas



### Blinn College Building –Phase III – Bryan Campus

“College Park Center” Renovations

\$7.5m, 58,000 sf total

JMB role/phase- Chf/SD, DD, CD, Permit

### Blinn College Building – Phase III – Bryan Campus

Bookstore Building. New

JMB role/phase- Chf/SD, DD, CD, Permit

### Austin College – Worthem Center

JMB role/phase- Chf/SD, DD, CD



### Austin College

Three (3) Student Housing Projects, Renovations

JMB role/phase- Chf/SD, DD, CD

### Grayson Community College – Admin Building

Adaptive Design, Addition/Renovations

\$4.7m, 24,000 sf total

JMB role/phase- Chf/SD, DD, CD, Permit

### Grayson Community College – South Grayson Center

\$5.5m, 34,000 sf total

JMB role/phase- Chf/SD, DD, CD, Permit



### SCOPE OF SERVICES/ROLES/PHASES

#### PROVIDED BY J. MATTHEW BROWN, AIA, REFP

JMB role/phase – Chf = Chief Architect, PA = Project Architect, JC = Job Captain – Program, SD = Schematics Design, DD = Design Development, CD = Construction Documents, Permit/Bid, CA = Construction Administration



### ATTRIBUTION OF CREDITS

Architectural Firm of Record: SHW Group, LLP

Architectural Services: J. Matthew Brown, AIA, REFP

### FIRM CONTACT

SHW Group, LLP – Mark Lam, OIC – 713.877.0900

### CONTACT J. MATTHEW BROWN, AIA, REFP

JMB2 Architecture Cooperative

J. Matthew Brown, AIA, REFP - 281.980.0900

**DISCLAIMER:** JMB2 Architecture, Inc. is not the architectural firm of record for the above project. Rather, J. Matthew Brown, AIA, REFP served as a project team member, providing the above listed role(s), during the above listed project phases, while engaged with SHW Group, LLP as either firm partner or employee.

# J. Matthew Brown, AIA, REFP – Personal Project Type Sampling



## Natatoriums

### Various District Clients

Houston Area, Texas and National Projects

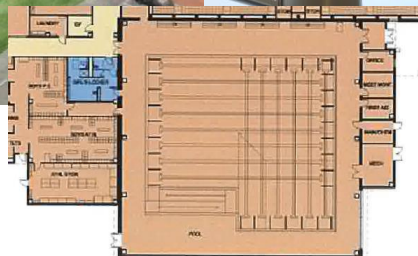

## NATATORIUM PROJECTS

### Ft Bend ISD- Don Cook FBISD District Natatorium

1998, 39,471sf, \$6.6m, 50yd/m, warm up pool, 3x dive, 780 seats  
JMB role/phase- Chf, Program, SD, DD, CD, Permit/Bid, assist CA

### \*Tomball ISD-TISD District Natatorium

2003, 22,150sf, \$4.9m, 25yd/m, 2x warm up lanes, 2x dive, 252 seats  
JMB role/phase- Chf, Program, SD, DD, CD, Permit/Bid, assist CA

### Frisco ISD-FISD District Natatorium

2003, 38,871sf, \$8.0m, 50yd/m, 2x warm up lanes, 3x dive, 804 seats  
JMB role/phase- Chf, Program, SD, DD, CD, Permit/Bid, assist CA

### Cy-Fair- MS #14 (School Natatorium)

2005, 10,000sf, 25m/yd, 120 seat  
JMB role/phase- Chf, Program, SD

### \*Spring-Andy Dekaney HS- (District Natatorium)

2007, 13,765, 25yd/m, 2x dive, 75 seats  
JMB role/phase- JC, Program, SD

### AZ- Amphitheater HS (School/District/Public Natatorium)

1999, Outdoor swimming lanes/recreation pool combine + beach,  
JMB role/phase- PA, Program, SD, DD

### DC- Woodson HS- (School/Public Natatorium)

Not built, 10,000sf, 25yd/m, 1x dive, 120 seats  
JMB role/phase- Chf, Program, SD, DD

## REMARKS

Natatorium and Aquatics facilities have a variety of uses from private to public and from competition to pleasure and with these different uses along with the different regions in which they exist come many sizes, shapes and designs. The project list and pictures represent a variety of examples in which J. Matthew Brown, AIA has provided services.

## \*RECOGNITION

Tomball ISD District Natatorium- 2004 TASA/TASB Design Award  
Andy Dekaney High School- 2008 TASA/TASB Caudill Award

## SCOPE OF SERVICES/ROLES/PHASES

### PROVIDED BY J. MATTHEW BROWN, AIA, REFP

JMB role/ phase-Chf = Chief Architect, PA = Project Architect, JC = Job Captain- Program, SD = Schematics Design, DD = Design Development, CD = Construction Documents, Permit/Bid, CA = Construction Admin.

## ATTRIBUTION OF CREDITS

Architectural Firm of Record: **SHW Group, LLP**

Architectural Services Provided by: J. Matthew Brown, AIA, REFP

## FIRM CONTACT

SHW Group, LLP – Mark Lam, OIC – 713.877.0900

### CONTACT J. MATTHEW BROWN, AIA, REFP

JMB2 Architecture Cooperative – J. Matthew Brown, AIA – 713.922.7211

**DISCLAIMER:** JMB2 Architecture, Inc. is not the architectural firm of record for the above project. Rather, J. Matthew Brown, AIA, REFP served as a project team leader, providing the above listed role(s), during the above listed project phases, while engaged with **SHW Group, LLP** as either firm partner or employee.





## Career & Technical Education Facilities – Project Sampling

### Various Clients

Houston Area, Texas and National Projects



### JMB2 – SPOTLIGHTED PROJECTS

- **SISD - Sealy High School 2019 CTE Projects, TX**
  - Livestock Pavilion – 13,630 SF ± (New Building)
  - Culinary Arts – 3,500 SF ± (Addition & Minor Renovation)
- **GCCISD - Stuart Career Tech High School P2, TX**  
**JMB2 - Educational Facilities Planning and Conceptual Design Services –**  
*(P2+Full Campus Master Plan for Architect of Record: Pfluger Architects)*
  - P2 – Site, Culinary Arts, AutoTech/Collision, Horticulture/Floral, Mfr./Const. Tech., IT, Kitch/Dining...
- **SJCP - Strake Jesuit College Prep. Library Revamp, TX**
  - TV Studio & MDF relocate, 2x new 30 seat IT Labs, misc. renovations

### J. MATTHEW BROWN, AIA – PERSONAL SPOTLIGHTED PROJECTS

DISCLAIMER: JMB2 Architecture, Inc. is not architect of record for the following projects. Rather, J. Matthew Brown, AIA, REFP served as project team leader (providing various material roles), while engaged with SHW Group, LLP as firm partner or employee.

- **GCCISD - Goose Creek Memorial High School, TX**
  - Culinary Arts, Marketing, Ag. Science/Application, Horticulture/Floral, Engineering/Application, Multi-Media, Health Science, Business & BCIS, Law Enforcement, etc...
- **Spring ISD - Carl Wunsche Sr. High School, TX** *\*Caudill & MacConnell Awards*
  - Legal Studies/Court, Criminal & Forensics, Business, Finance/Bank, Parenting/Early Childhood Dev./Teacher Prep., Child Nutrition, Travel/Tourism, Culinary Arts/Demonstration, Coffee/Snack/Shop, IT Eng./Lab, Mfr'g./Lab, Multi-Media, Bio-Sciences, Medical/Nursing, Dental, EMT, Health, Speech, AutoTech/Collision/Shop, Aquatic & Environment Sciences, Veterinary Sciences/Clinic, Horticulture/Floral, Computer Network/Maint./Shop, Electronics/Lab, CADD, Animation, Digital Arts, Audio/TV Studio/Production/Theatre, etc...
- **Strake Jesuit College Preparatory Student Center, Dining Hall, Chapel**
  - Audio/TV Production/Control/Studio/CCTV, IT/Graphics, Digital Arts, Business & Commerce/Shops, etc...
- **QISD - Quinlan High School**
  - AutoTech, Ag. Science, IT/CADD, Child Dev., Culinary Arts, etc...
- **CISD - Celina Vocational Center**
  - AutoTech, Ag. Science, IT/CADD, Child Dev., Culinary Arts, etc...

### SAMPLING OF ADDL. SCHOOLS WITH MISC. CTE PROGRAMS

- George Bush HS, Forestview HS (+ Robotics), McKamy & JL Huffines MS, Fauquier Liberty HS (+ Robotics), Northwest HS, etc...



NOTE: Project photos are from JMB2 Architecture Photo Archives and J. Matthew Brown, AIA Project Image Archives